

### Residential Grade CR1 Series

#### Body Style 1

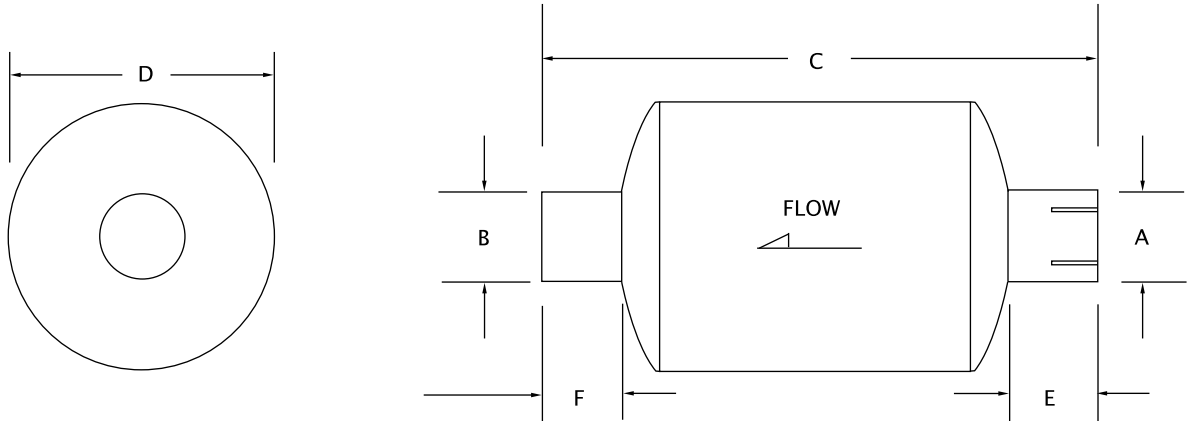

Model	A Inlet ID	B Outlet OD	C Overall Length	D Body DIA Nominal	E Inlet Cuff Length	F Outlet Tube Length
CR1-15-0001	1.5	1.5	14.5	8	3	2
CR1-02-0001	2	2	16.5	8	3	2
CR1-25-0001	2.5	2.5	18	10	3	2
CR1-03-0001	3	3	20.5	12	3	2
CR1-35-0001	3.5	3.5	22.5	12	3	2
CR1-04-0001	4	4	28	12	4	2.5
CR1-05-0001	5	5	31	16	4	2.5
CR1-06-0001	6	6	37	16	4	2.5

### Features

The new Belmar Compact Silencer offers a high level of attenuation in a small, light weight package. Its smaller size allows it to be installed in areas where space is at a premium. These silencers can be customized to fit your particular application and installation needs.

### Applications

- For use in areas where space is limited
- Can be mounted in any position
- A wide range of brackets are available to complete the exhaust system
- Average noise level reductions: 22-28 dBA

### Construction

- Internally reinforced inlet for direct mounting
- Carbon steel construction is standard, painted with high temperature black paint. Other materials, such as stainless steel or aluminized steel are available.